

CORNER RECORD

Agency Index CR22-046

Document Number 011-278-02 (ADJ)

City of SAN RAFAEL County of MARIN, California

Brief Legal Description MONUMENT LOCATED WITHIN THIRD STREET AT TAMALPAIS AVENUE

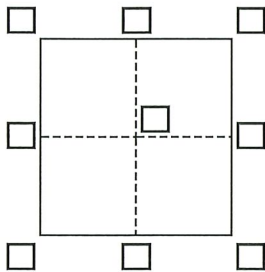

CORNER TYPE

Government Corner Control
 Meander Property
 Rancho Other

Date of Survey January - February 2022

COORDINATES (Optional)

N. _____ E. _____

Elevation _____

Units Metric U.S. Survey Foot

Horizontal Datum _____

Zone _____ Epoch Date _____

Vertical Datum _____

Complies with Public Resources Code §§8801-8819
 Complies with Public Resources Code §§8890-8902

PLS Act Ref.: 8765(d) 8771 8773 Other:

Corner/Monument: Left as found Established Rebuilt Pre-Construction
 Found and tagged Reestablished Referenced Post-Construction

Narrative of corner identified and monument as found, set, reset, replaced, or removed:

See sheet #2 for description(s):

FOUND NAIL AND TAG, SET IN SIDEWALK, WITHIN THIRD STREET AT TAMALPAIS AVENUE, LABELED PLS 8806, PER PENDING MAP.

FOUND NAIL AND TAG, SET IN SIDEWALK, WITHIN THIRD STREET AT TAMALPAIS AVENUE, LABELED PLS 8806, PER PENDING MAP.

SET REFERENCE POINTS AS SHOWN ON PAGE 2 TO PRESERVE MONUMENT LOCATION.

SURVEYOR'S STATEMENT

This Corner Record was prepared by me or under my direction in conformance with

the Professional Land Surveyors Act on May 10, 2022

Signed [Signature] P.L.S. or R.C.E. No. 9387



COUNTY SURVEYOR'S STATEMENT

This Corner Record was received 8/4/22

and examined and filed 9/19/22

Signed T. W. Park P.L.S. or R.C.E. No. 8176

Title County Surveyor

County Surveyor's Comment



DOC# 011-278-02 (ADJ)
 AGENCY INDEX: CR22-046

Graphic Scale (in feet)



1 inch = 20 ft.



3RD STREET (WESTBOUND - ONE WAY DIRECTION)

92.77'

SET NAIL AND TAG PLS 9387 IN CURB

79.47'

FOUND NAIL AND TAG PLS 8806 SET IN SIDEWALK PER PENDING MAP

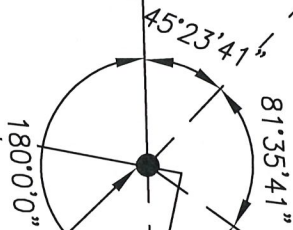

FOUND NAIL AND TAG PLS 8806 SET IN SIDEWALK PER PENDING MAP

LANDS OF 703 3RD STREET
 APN: 011-278-02
 703 3RD ST, SAN RAFAEL, CA 94901

TAMALPAIS AVENUE

SET NAIL AND TAG PLS 9387 IN CURB

57.63'

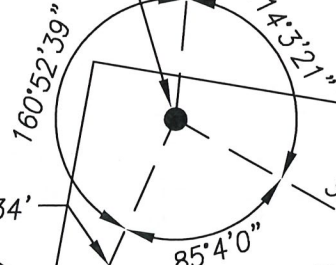

SET NAIL AND TAG PLS 9387 IN CURB

SET NAIL AND TAG PLS 9387 IN CURB

LANDS OF GOLDEN GATE BRIDGE HWY AND GOLDEN TRANS
 APN: 011-279-01
 850 TAMALPAIS AVE, SAN RAFAEL, CA 94901

LEGEND

- TIE TO PRE-CONSTRUCTION REFERENCE POINT
- △ CONTROL POINT AS NOTED
- FOUND MONUMENT AS NOTED

CSW | ST2

CSW/Stuber-Stroeh Engineering Group, Inc.

Civil & Structural Engineers | Surveying & Mapping | Environmental Planning
 Land Planning | Construction Management

45 Leveroni Court
 Novato, CA 94949

tel: 415.883.9850
 fax: 415.883.9835

http://www.cswst2.com

© 2019

Rev. -

Date: 05/10/22

Job No. 1920101.50

Scale: 1" = 20'

**MONUMENT PRESERVATION
 CORNER RECORD**

MONUMENT LOCATED WITHIN 3RD STREET AT TAMALPAIS AVENUE

SAN RAFAEL

MARIN

CALIFORNIA